

# STAKE FOLD

INSTALLATION INSTRUCTIONS | DECEMBER 2022

## 5 OPTIONAL Mounting the snoot

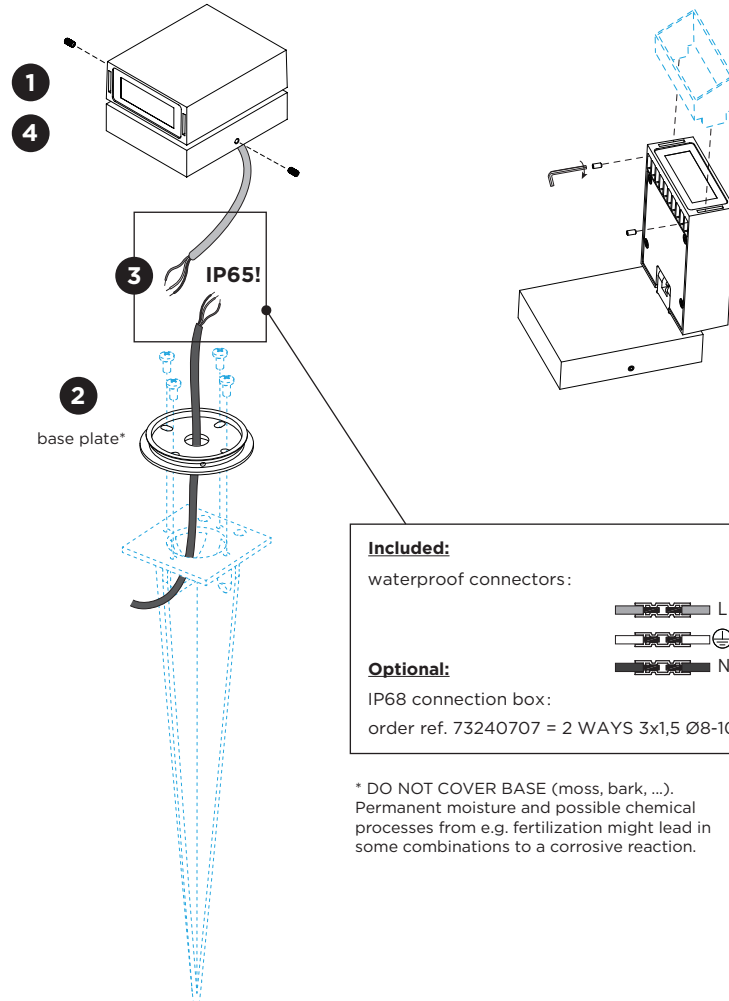

base plate

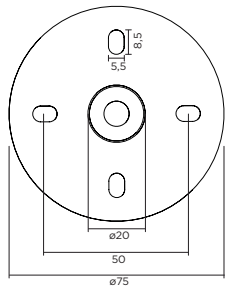

OPTIONAL  
snoot dimensions  
90019004

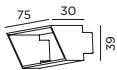

OPTIONAL  
groundspike dimensions  
90013107



## DIMENSIONS

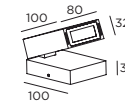

## MOUNTING INSTRUCTION

- 1** Remove the base plate from the luminaire by loosening the side screws.
- 2** Fix the base plate to the surface (screws not included).  
OPTIONAL  
Fix the base plate to the groundspike (screws are included).
- 3** **POWER CONNECTION**  
Connect the wires with waterproof connectors.  
Connect to 220-240V.  
Please see the detail method in the separate instruction sheet.
- 4** Attach the fixture back to the base plate with the side screws.
- 5** **OPTIONAL**  
Mount the snoot on the Stake and lock it with the allen screws.

# STAKE FOLD

INSTALLATION INSTRUCTIONS | DECEMBER 2022

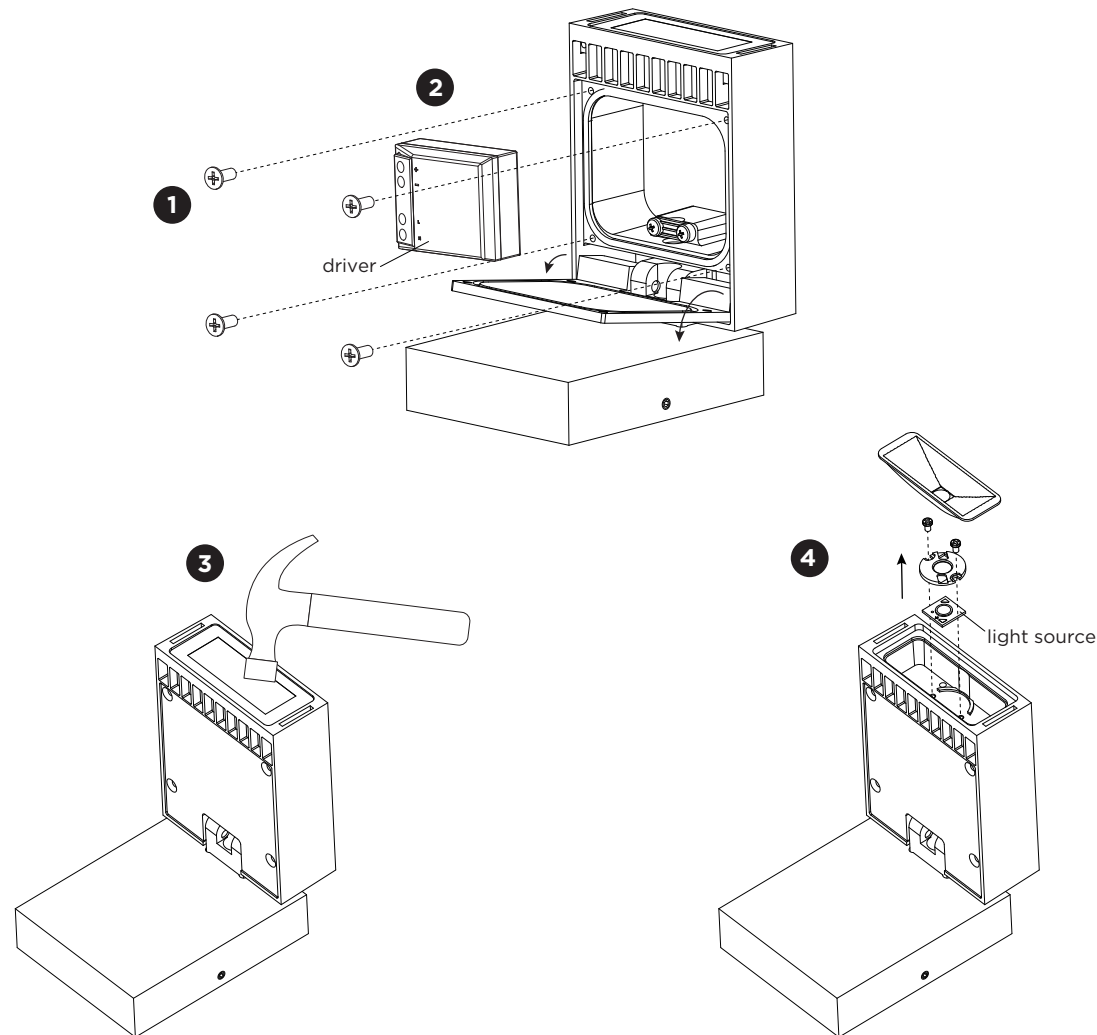

## DISMOUNTING AND RECYCLING INSTRUCTIONS

### Light source & driver

- 1** Loosen the screws and tilt the cover.
- 2** The driver can be removed by loosening the cables.
- 3** Break the glass.
- 4** Take out the reflector and unscrew the holder to remove the light source.

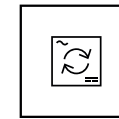

The driver can be replaced by the end user.

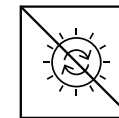

The light source is not replaceable.



This luminaire contains a light source with the energy class F.