

unex 
lighting · made for you

**BETRIEBSANLEITUNG FÜR
PENDELLEUCHTE**

Solea Round Ø655mm

**MODE D'EMPLOI POUR
SUSPENSION**

Solea Round Ø655mm

**ISTRUZIONI DI FUNZIONAMENTO PER
APPARECCHIO A SOSPENSIONE**

Solea Round Ø655mm

**OPERATING MANUAL FOR
PENDANT LUMINAIRE**

Solea Round Ø655mm

160-262-70 / weiss
160-263-70 / schwarz

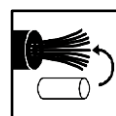
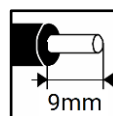
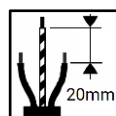
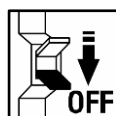
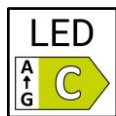
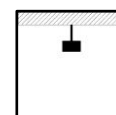
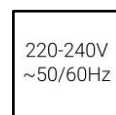
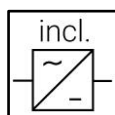

DE Die Montage und Inbetriebnahme darf nur von autorisiertem Fachpersonal durchgeführt werden (Elektroinstallateur). Die Leuchte dient ausschliesslich der Beleuchtung und ist entsprechend den Errichtungsbestimmungen zu installieren. Eine andere Nutzung oder ein anderer Einbau gilt als nicht „bestimmungsgemäss“.

Achtung! Während der Verdrahtung und Installation der Leuchten und Versorgungsgeräte immer spannungslos arbeiten. Nichtbeachten kann zur Zerstörung der LED-Module führen. **Bei Defekt zurück an Hersteller.** Die Montageanleitung muss aufbewahrt werden. Technische Änderungen vorbehalten.

FR Le montage et la mise en service ne peuvent être effectués que par du personnel spécialisé autorisé (installateur électrique). Le luminaire sert uniquement à éclairer et doit être installé conformément aux dispositions d'édification. Une autre utilisation ou intégration est considérée comme «non conforme aux dispositions».

Attention! Toujours travailler hors tension lors du câblage et de l'installation des luminaires et unités d'alimentation. Le non-respect de cette consigne peut entraîner la destruction des modules à LED. **Retourner au fabricant en cas de défaut.** L'instruction de montage doit être conservée. Sous réserve de modifications.

IT Montaggio e messa in funzione possono essere effettuati solo da personale specializzato autorizzato (elettoinstallatori). Il proiettore serve esclusivamente a scopo di illuminazione e deve essere installato secondo le disposizioni di montaggio. Un altro utilizzo o un'altra modalità di incasso sono considerati "non conformi".

Attenzione! Lavorare sempre in assenza di tensione mentre si cablano e si installano gli apparecchi e le unità di alimentazione. In caso contrario i moduli LED possono andare distrutti! **In caso di guasto rispedire il proiettore al produttore.** Le istruzioni di montaggio devono essere conservate. I dati tecnici possono subire modifiche senza preavviso.

EN Installation and commissioning may only be carried out by authorised technical personnel (electrical fitters). The luminaire is designed solely for lighting and is to be installed according to the installation instructions. Any other use or any other installation is considered to be improper.

Caution! Make sure that the luminaires and power supply units are always disconnected from the main supply during wiring and installation work. Otherwise, the LED modules may be destroyed. **Return to manufacturer if defects are found.** Assembly instructions must be kept. Subject to technical change without notice.

Technische Änderungen vorbehalten / Les détails techniques sont sujet à des changements.

Modifiche tecniche riservate / Technical Details are subject to change.

Seite 1/5, 08.05.2024 © unex lighting AG, Flüelastrasse 12, 8048 Zürich

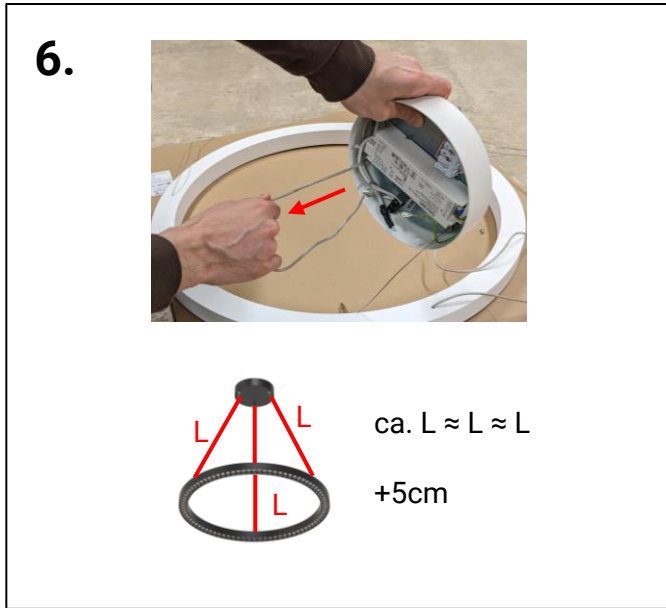
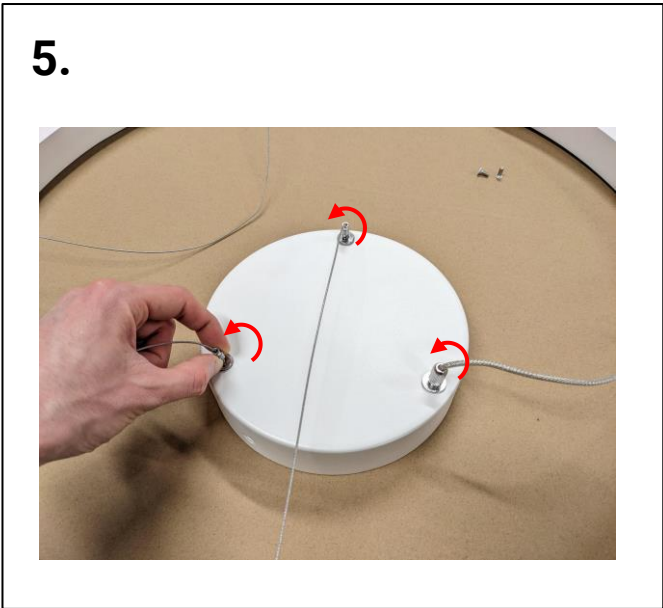
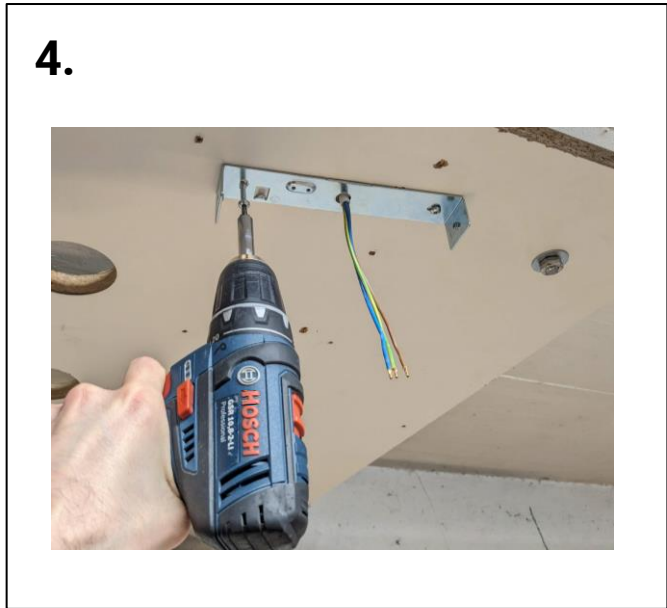
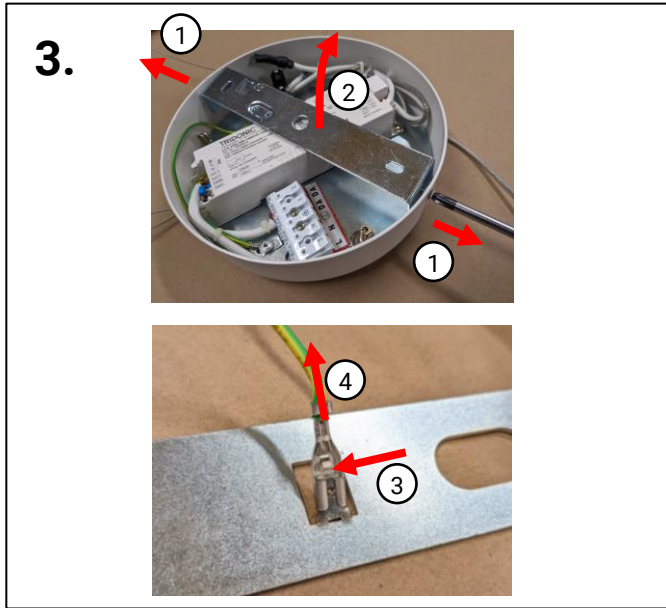
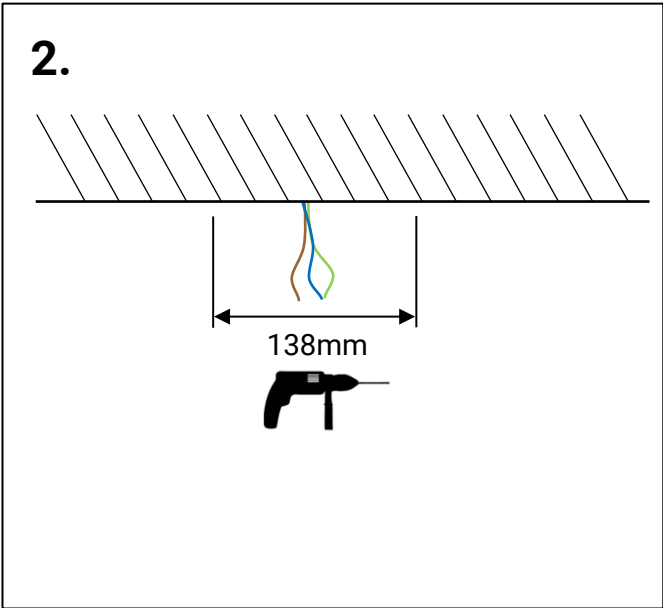
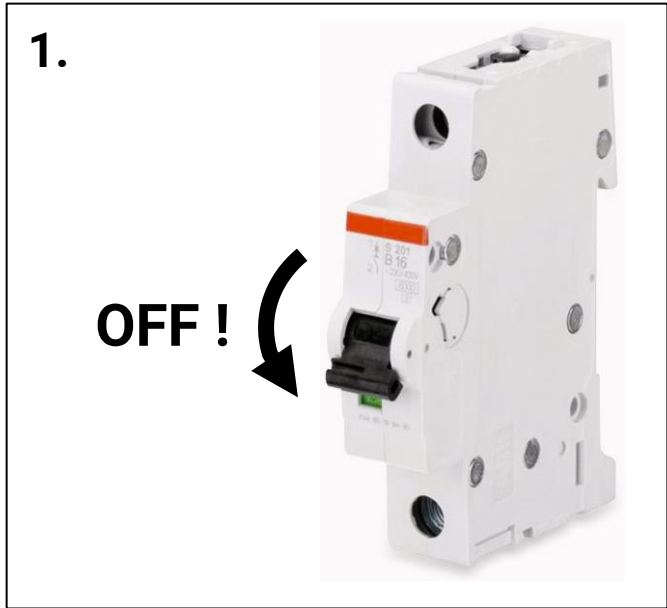

7.

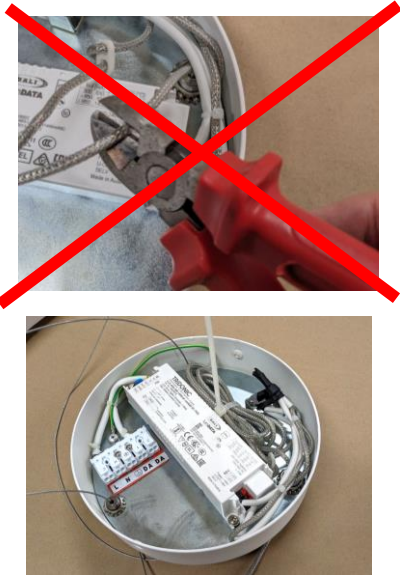

8. optional



9.

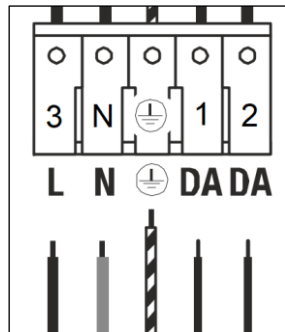

10.

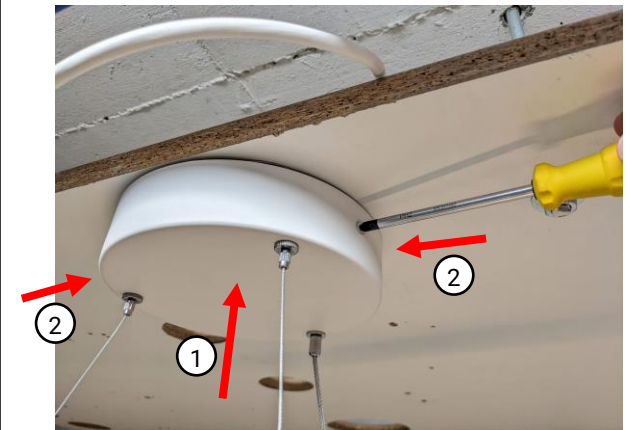

11.

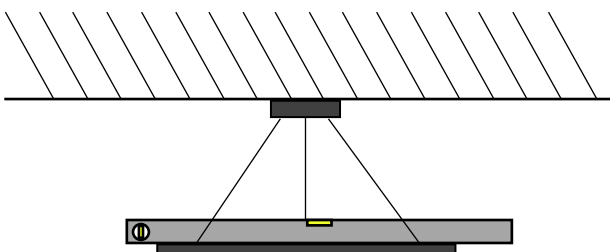
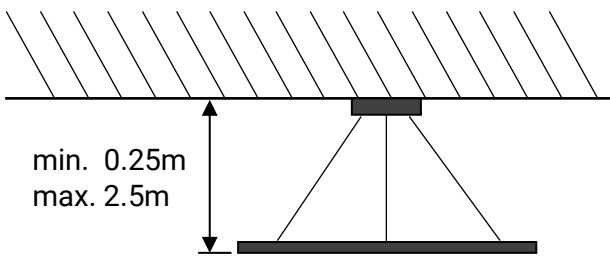
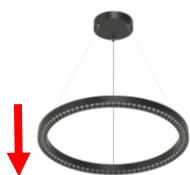

12.



13.



DE

Reinigung und Pflege

Reinigung nur mit trockenem oder feuchtem Mikrofasertuch.

Lichtquelle ersetzen

Die Lichtquelle ist nur durch eine Fachkraft austauschbar.

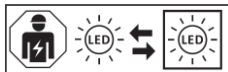

Netzteil ersetzen

Das Betriebsgerät ist nur durch eine Fachkraft austauschbar.

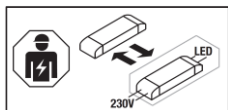

Energieeffizienz

Dieses Produkt enthält eine Lichtquelle der Energieeffizienzklasse C.

FR

Nettoyage et entretien

Nettoyage seulement avec chiffon microfibre sec ou humide.

Remplacer la source lumineuse

La source lumineuse peut uniquement être remplacée par un spécialiste.

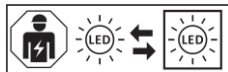

Remplacer le bloc d'alimentation

L'auxiliaire de commande peut uniquement être remplacé par un spécialiste.

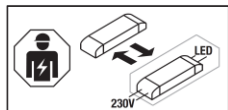

Efficacité énergétique

Ce produit contient une source lumineuse de la classe d'efficacité énergétique C.

IT

Cura e pulizia

Pulire solo con un panno in microfibra asciutto o umido.

Sostituire la sorgente luminosa

La sorgente luminosa può essere sostituita solo da personale autorizzato.

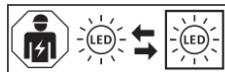

Sostituire l'alimentatore

Il dispositivo di alimentazione può essere sostituito solo da personale autorizzato.

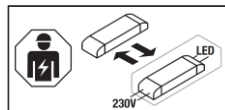

Efficienza energetica

Questo prodotto contiene una sorgente luminosa con classe di efficienza energetica C.

EN

Cleaning and care

Only use dry or moist microfiber cloth for cleaning.

Replacement of light source

The light source is only replaceable by a professional.



Replacement of power supply

The separate control unit is only replaceable by a professional.

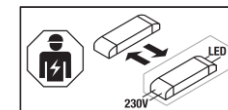

Energy efficiency

This product contains a light source of the energy efficiency class C.